

NOTES

- FOR GENERAL NOTES REFER TO DRAWINGS 1000-CI-0005 AND 1000-CI-0006.
- ALL LIGHT POTS SET BACK 1.0m TYPICAL FROM KERB FACE.
- DRAINAGE AND STREET LIGHTING DESIGN SUBJECT TO FURTHER INVESTIGATION.
- BUS PLINTH RELOCATION SUBJECT TO TFNSW APPROVAL.
- INTERSECTION MODIFICATIONS SUBJECT TO TFNSW APPROVAL.
- KERBS SHOWN AT 150mm WIDTH. AS PART OF DETAILED DESIGN, THIS WILL BE UPDATED TO 300mm TO SUIT A STONE KERB. THIS WILL IMPACT WIDTH OF LANDSCAPING ALONG CROWN STREET.

LEGEND

- EXTENT OF WORKS
- ① CONTINUOUS FOOTPATH TREATMENT AND BUILD OUT
- ② CONTINUOUS FOOTPATH TREATMENT ONLY
- ③ IN-LANE BUS STOP
- ③A KERBSIDE BUS STOP
- ④ RAISED PEDESTRIAN CROSSING
- ⑤ SIGNALISED RAISED PEDESTRIAN CROSSING
- ⑥ EXISTING RAISED THRESHOLD TO BE RENEWED
- ⑦ PROPOSED BUS STOP FLAG
- ⑧ EXISTING BUS STOP FLAG TO BE MAINTAINED
- ⑨ EXISTING BUS STOP FLAG TO BE REMOVED
- PROPOSED TREE
- EXISTING TREES TO REMAIN
- TCS# 0000 TCS PLAN REFERENCE
- FOOTPATH WIDENING FOR STREET ACTIVATION
- FOOTPATH UPGRADE WITH CONCRETE UNIT PAVERS
- FOOTPATH REINSTATEMENT WITH GRANITE PAVERS
- FOOTPATH BUILD OUT
- CONTINUOUS FOOTPATH TREATMENT
- ROAD PAVEMENT (MILL AND RE-SHEET)
- ③ ③A BUS STOP
- EXISTING BRICK PAVING TO BE RETAINED
- EXISTING DINING ZONE TO BE RETAINED
- EXISTING DINING ZONE TO BE RELOCATED
- PROPOSED GARDEN BED WITH LOW GROWING SPECIES
- TREE PLANTING IN TREE PIT. TREE PLANTING DETAIL / TYPE TO BE COORDINATED WITH CoS
- PROPOSED STREETLIGHT POLE
- EXISTING STREETLIGHT POLE

This drawing is confidential and shall only be used for the purpose of this project. The signing of this title block confirms the design and drafting of this project have been prepared and checked in accordance with the AECOM quality assurance system to ISO 9001-2000.

AECOM
CONSULTANT
AECOM Australia Pty Ltd
A.B.N 20 093 846 925
www.aecom.com

PROJECT
Crown Street Improvements

CLIENT
CITY OF SYDNEY
SYDNEY CIVIL

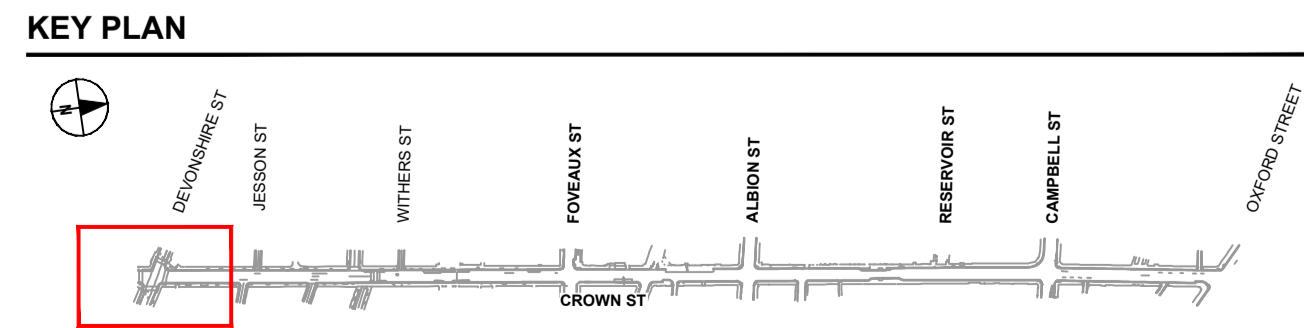
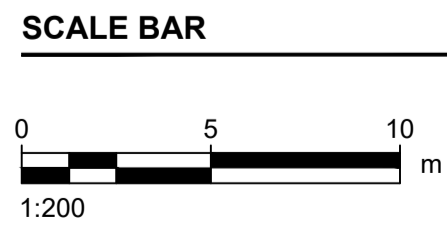

PROJECT MANAGEMENT INITIALS

ZJ	GS	RM
DESIGNER	CHECKED	APPROVED

PROJECT DATA

DATUM	MGA56	SURVEY	GDA 2020
-------	-------	--------	----------

ISSUE/REVISION

I/R	DATE	DESCRIPTION
04	29.06.2023	CONCEPT DESIGN
03	24.03.2023	CONCEPT DESIGN
02	20.06.2022	CONCEPT DESIGN
01	15.02.2022	CONCEPT DESIGN

PROJECT NUMBER
60616465
SHEET TITLE
GENERAL ARRANGEMENT PLAN
SHEET 1
SHEET NUMBER
60616465-019-SHT-1000-CI-0101

FOR INFORMATION ONLY

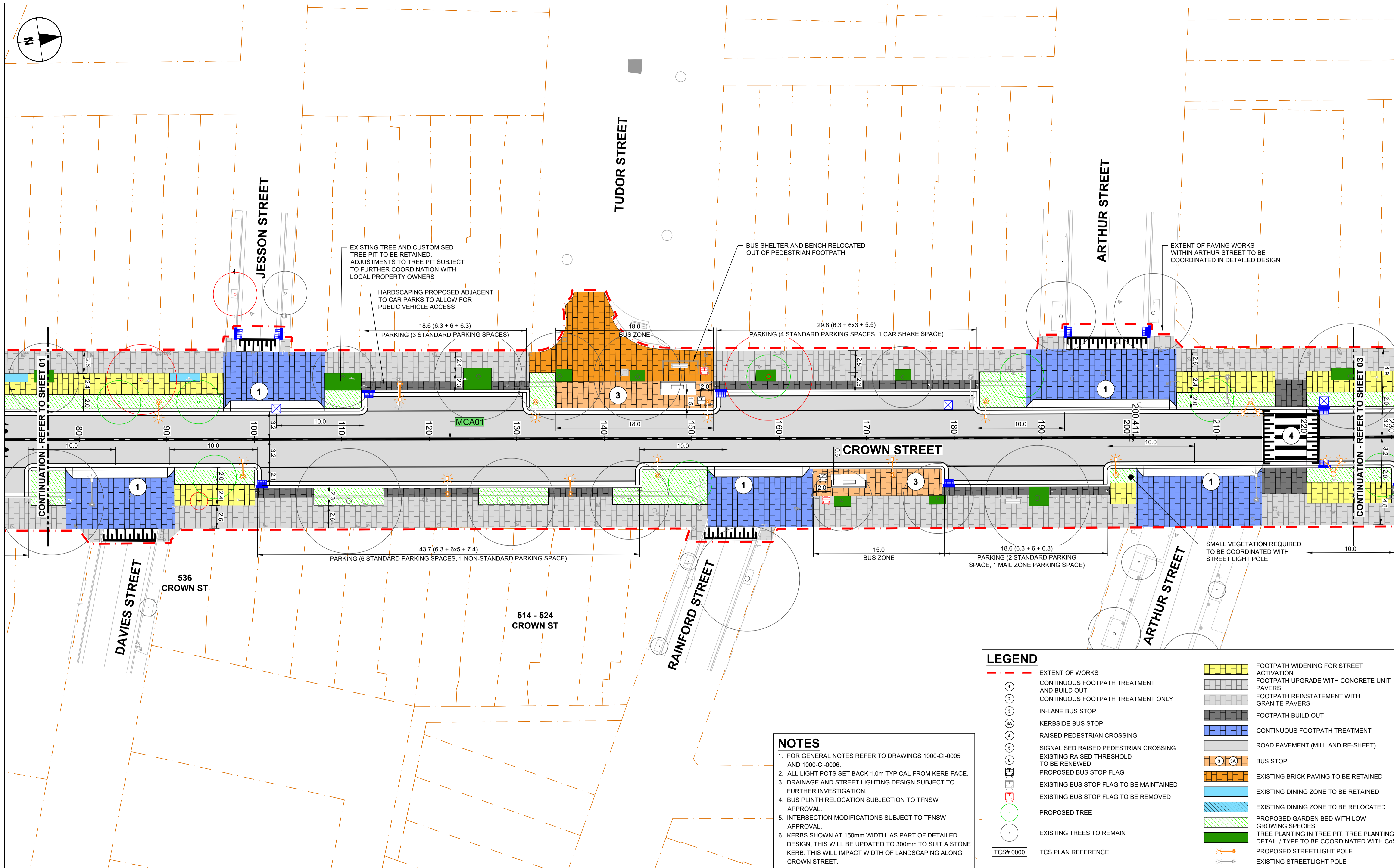

CONTINUATION - REFER TO SHEET 01

CONTINUATION - REFER TO SHEET 03

NOTES

- FOR GENERAL NOTES REFER TO DRAWINGS 1000-CI-0005 AND 1000-CI-0006.
- ALL LIGHT POTS SET BACK 1.0m TYPICAL FROM KERB FACE.
- DRAINAGE AND STREET LIGHTING DESIGN SUBJECT TO FURTHER INVESTIGATION.
- BUS PLINTH RELOCATION SUBJECT TO TfNSW APPROVAL.
- INTERSECTION MODIFICATIONS SUBJECT TO TfNSW APPROVAL.
- KERBS SHOWN AT 150mm WIDTH. AS PART OF DETAILED DESIGN, THIS WILL BE UPDATED TO 300mm TO SUIT A STONE KERB. THIS WILL IMPACT WIDTH OF LANDSCAPING ALONG CROWN STREET.

LEGEND

	EXTENT OF WORKS		FOOTPATH WIDENING FOR STREET ACTIVATION
	CONTINUOUS FOOTPATH TREATMENT AND BUILD OUT		FOOTPATH UPGRADE WITH CONCRETE UNIT PAVERS
	CONTINUOUS FOOTPATH TREATMENT ONLY		FOOTPATH REINSTATEMENT WITH GRANITE PAVERS
	IN-LANE BUS STOP		FOOTPATH BUILD OUT
	KERBSIDE BUS STOP		CONTINUOUS FOOTPATH TREATMENT
	RAISED PEDESTRIAN CROSSING		ROAD PAVEMENT (MILL AND RE-SHEET)
	SIGNALISED RAISED PEDESTRIAN CROSSING		BUS STOP
	EXISTING RAISED THRESHOLD TO BE RENEWED		EXISTING BRICK PAVING TO BE RETAINED
	PROPOSED BUS STOP FLAG		EXISTING DINING ZONE TO BE RETAINED
	EXISTING BUS STOP FLAG TO BE MAINTAINED		EXISTING DINING ZONE TO BE RELOCATED
	EXISTING BUS STOP FLAG TO BE REMOVED		PROPOSED GARDEN BED WITH LOW GROWING SPECIES
	PROPOSED TREE		TREE PLANTING IN TREE PIT. TREE PLANTING DETAIL / TYPE TO BE COORDINATED WITH CoS
	EXISTING TREES TO REMAIN		PROPOSED STREETLIGHT POLE
	TCS PLAN REFERENCE		EXISTING STREETLIGHT POLE

This drawing is confidential and shall only be used for the purpose of this project. The signing of this title block confirms the design and drafting of this project have been prepared and checked in accordance with the AECOM quality assurance system to ISO 9001-2000.

AECOM
CONSULTANT
AECOM Australia Pty Ltd
A.B.N 20 093 846 925
www.aecom.com

PROJECT
Crown Street Improvements

CLIENT
CITY OF SYDNEY
SYDNEY CIVIL

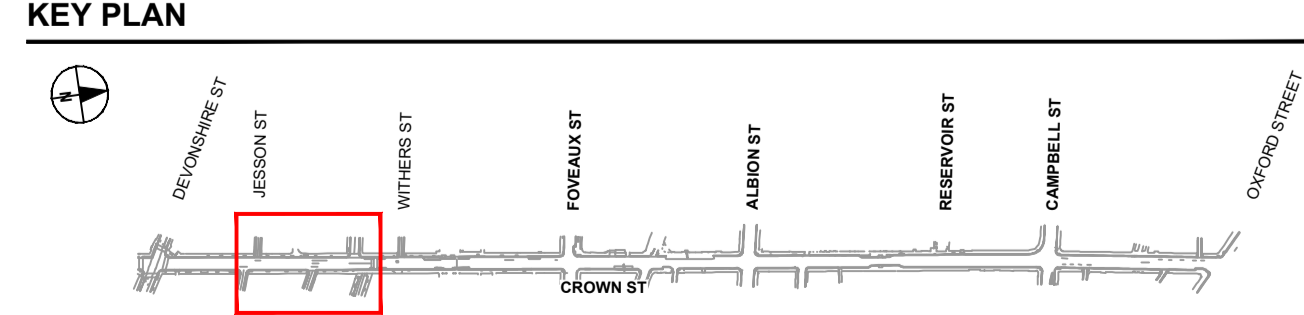
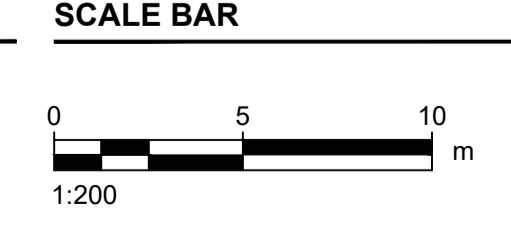

PROJECT MANAGEMENT INITIALS

ZJ	GS	RM
DESIGNER	CHECKED	APPROVED

PROJECT DATA

DATUM	MGA56	SURVEY	GDA 2020
-------	-------	--------	----------

ISSUE/REVISION

I/R	DATE	DESCRIPTION
04	29.06.2023	CONCEPT DESIGN
03	24.03.2023	CONCEPT DESIGN
02	20.06.2022	CONCEPT DESIGN
01	15.02.2022	CONCEPT DESIGN

PROJECT NUMBER
60616465

SHEET TITLE
GENERAL ARRANGEMENT PLAN
SHEET 2

SHEET NUMBER
60616465-019-SHT-1000-CI-0102

FOR INFORMATION ONLY

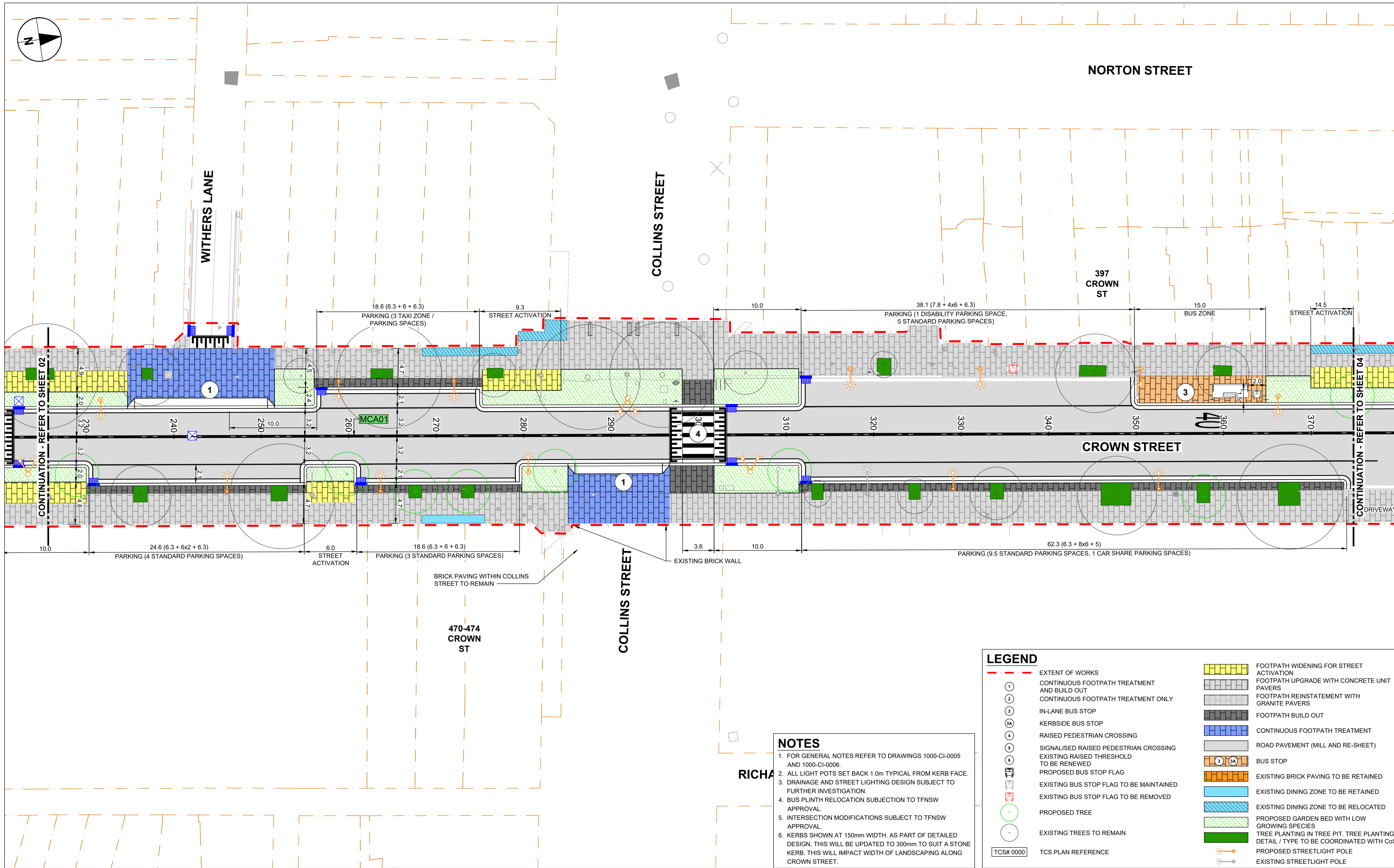

NOTES

- FOR GENERAL NOTES REFER TO DRAWINGS 1000-CI-0005 AND 1000-CI-0006.
- ALL LIGHT POTS SET BACK 1.0m TYPICAL FROM KERB FACE.
- DRAINAGE AND STREET LIGHTING DESIGN SUBJECT TO FURTHER INVESTIGATION.
- BUS PLINTH RELOCATION SUBJECT TO TFNSW APPROVAL.
- INTERSECTION MODIFICATIONS SUBJECT TO TFNSW APPROVAL.
- KERBS SHOWN AT 150mm WIDTH. AS PART OF DETAILED DESIGN, THIS WILL BE UPDATED TO 300mm TO SUIT A STONE KERB. THIS WILL IMPACT WIDTH OF LANDSCAPING ALONG CROWN STREET.

LEGEND

	EXTENT OF WORKS		FOOTPATH WIDENING FOR STREET ACTIVATION
	CONTINUOUS FOOTPATH TREATMENT AND BUILD OUT		FOOTPATH UPGRADE WITH CONCRETE UNIT PAVERS
	CONTINUOUS FOOTPATH TREATMENT ONLY		FOOTPATH REINSTATEMENT WITH GRANITE PAVERS
	IN-LANE BUS STOP		FOOTPATH BUILD OUT
	KERBSIDE BUS STOP		CONTINUOUS FOOTPATH TREATMENT
	RAISED PEDESTRIAN CROSSING		ROAD PAVEMENT (MILL AND RE-SHEET)
	SIGNALISED RAISED PEDESTRIAN CROSSING		BUS STOP
	EXISTING RAISED THRESHOLD TO BE RENEWED		EXISTING BRICK PAVING TO BE RETAINED
	PROPOSED BUS STOP FLAG		EXISTING DINING ZONE TO BE RETAINED
	EXISTING BUS STOP FLAG TO BE MAINTAINED		EXISTING DINING ZONE TO BE RELOCATED
	EXISTING BUS STOP FLAG TO BE REMOVED		PROPOSED GARDEN BED WITH LOW GROWING SPECIES
	PROPOSED TREE		TREE PLANTING IN TREE PIT. TREE PLANTING DETAIL / TYPE TO BE COORDINATED WITH CoS
	EXISTING TREES TO REMAIN		PROPOSED STREETLIGHT POLE
	TCS PLAN REFERENCE		EXISTING STREETLIGHT POLE

This drawing is confidential and shall only be used for the purpose of this project. The signing of this title block confirms the design and drafting of this project have been prepared and checked in accordance with the AECOM quality assurance system to ISO 9001-2000.

AECOM
 CONSULTANT
 AECOM Australia Pty Ltd
 A.B.N 20 093 846 925
 www.aecom.com

PROJECT
 Crown Street Improvements

CLIENT
 CITY OF SYDNEY
 SYDNEY CIVIL

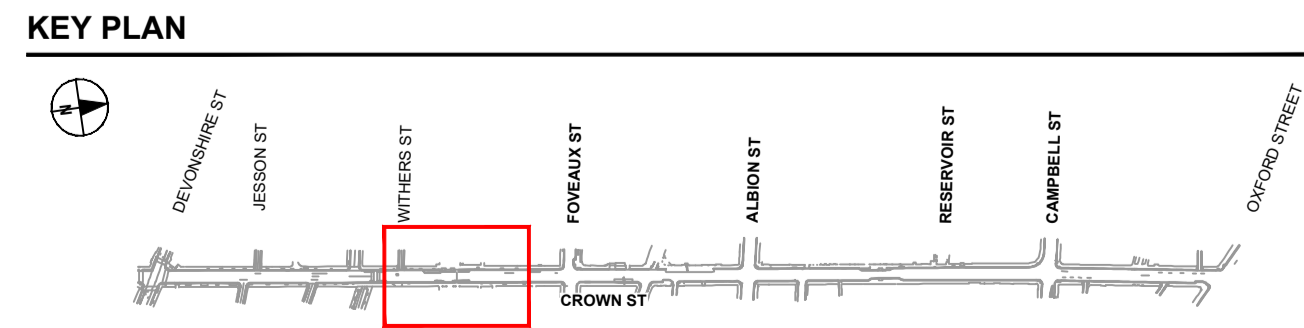
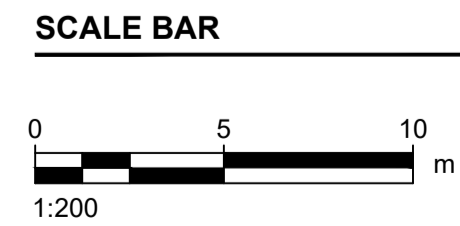

PROJECT MANAGEMENT INITIALS

ZJ	GS	RM
DESIGNER	CHECKED	APPROVED

PROJECT DATA

DATUM	MGA56	SURVEY	GDA 2020
-------	-------	--------	----------

ISSUE/REVISION

I/R	DATE	DESCRIPTION
04	29.06.2023	CONCEPT DESIGN
03	24.03.2023	CONCEPT DESIGN
02	20.06.2022	CONCEPT DESIGN
01	15.02.2022	CONCEPT DESIGN

PROJECT NUMBER
 60616465
SHEET TITLE
 GENERAL ARRANGEMENT PLAN
 SHEET 3
SHEET NUMBER
 60616465-019-SHT-1000-CI-0103

FOR INFORMATION ONLY

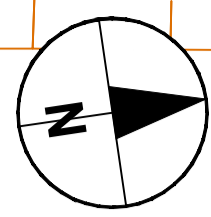

- ### NOTES
- FOR GENERAL NOTES REFER TO DRAWINGS 1000-CI-0005 AND 1000-CI-0006.
 - ALL LIGHT POTS SET BACK 1.0m TYPICAL FROM KERB FACE.
 - DRAINAGE AND STREET LIGHTING DESIGN SUBJECT TO FURTHER INVESTIGATION.
 - BUS PLINTH RELOCATION SUBJECT TO TfNSW APPROVAL.
 - INTERSECTION MODIFICATIONS SUBJECT TO TfNSW APPROVAL.
 - KERBS SHOWN AT 150mm WIDTH. AS PART OF DETAILED DESIGN, THIS WILL BE UPDATED TO 300mm TO SUIT A STONE KERB. THIS WILL IMPACT WIDTH OF LANDSCAPING ALONG CROWN STREET.

LEGEND

(1)	EXTENT OF WORKS	[Yellow hatched box]	FOOTPATH WIDENING FOR STREET ACTIVATION
(2)	CONTINUOUS FOOTPATH TREATMENT AND BUILD OUT	[Grey hatched box]	FOOTPATH UPGRADE WITH CONCRETE UNIT PAVERS
(3)	CONTINUOUS FOOTPATH TREATMENT ONLY	[Light grey hatched box]	FOOTPATH REINSTATEMENT WITH GRANITE PAVERS
(3A)	IN-LANE BUS STOP	[Dark grey hatched box]	FOOTPATH BUILD OUT
(4)	KERBSIDE BUS STOP	[Blue hatched box]	CONTINUOUS FOOTPATH TREATMENT
(5)	RAISED PEDESTRIAN CROSSING	[Light blue hatched box]	ROAD PAVEMENT (MILL AND RE-SHEET)
(6)	SIGNALISED RAISED PEDESTRIAN CROSSING	[Orange hatched box]	BUS STOP
(6A)	EXISTING RAISED THRESHOLD TO BE RENEWED	[Green hatched box]	EXISTING BRICK PAVING TO BE RETAINED
(6B)	PROPOSED BUS STOP FLAG	[Blue hatched box]	EXISTING DINING ZONE TO BE RETAINED
(6C)	EXISTING BUS STOP FLAG TO BE MAINTAINED	[Light blue hatched box]	EXISTING DINING ZONE TO BE RELOCATED
(6D)	EXISTING BUS STOP FLAG TO BE REMOVED	[Green hatched box]	PROPOSED GARDEN BED WITH LOW GROWING SPECIES
(7)	PROPOSED TREE	[Green hatched box]	TREE PLANTING IN TREE PIT. TREE PLANTING DETAIL / TYPE TO BE COORDINATED WITH CoS
(8)	EXISTING TREES TO REMAIN	[Green hatched box]	PROPOSED STREETLIGHT POLE
(9)	TCS PLAN REFERENCE	[Green hatched box]	EXISTING STREETLIGHT POLE

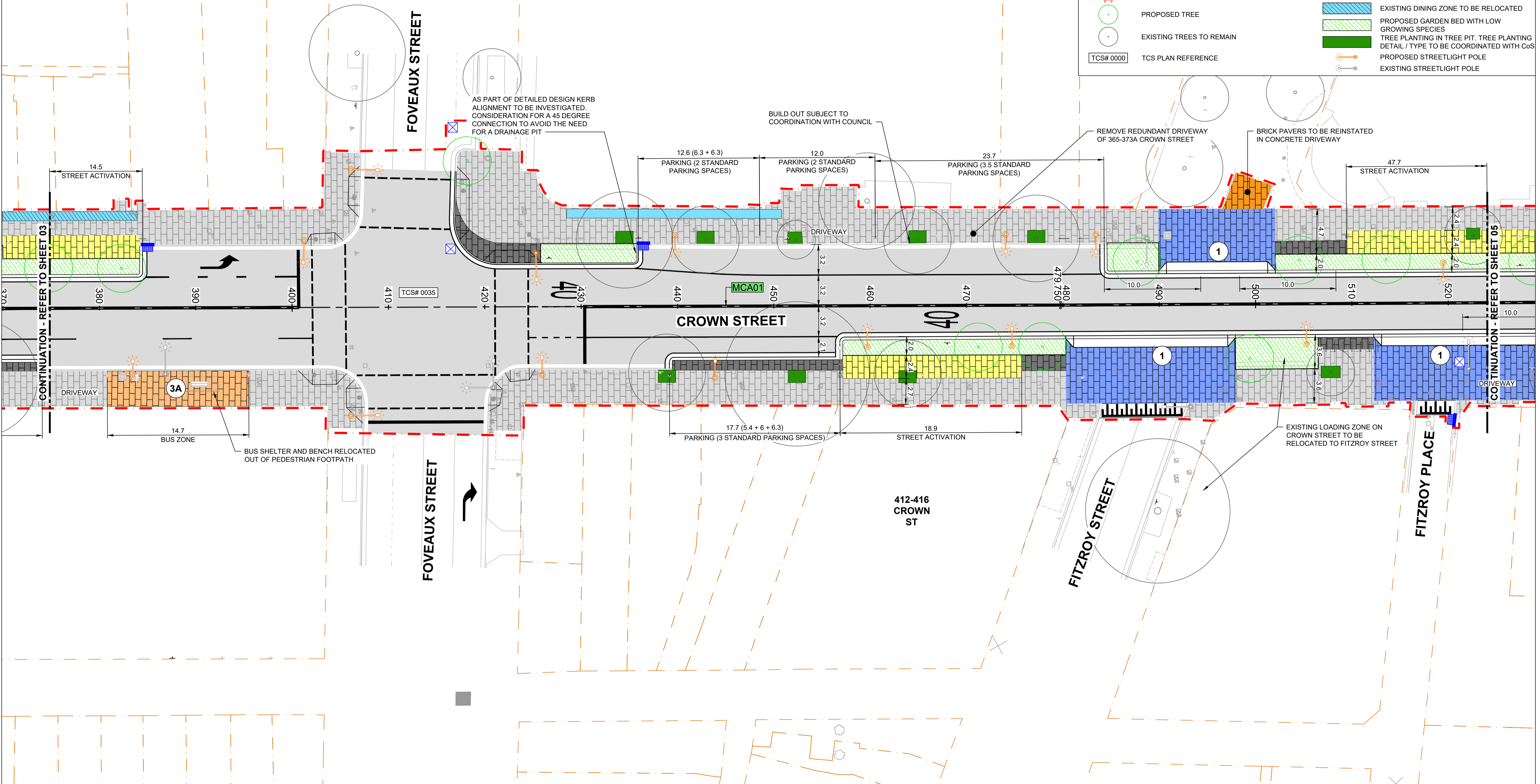

Last saved by: CONGH1(2023.06.27) Last Plotted: 2023.06.29
Filename: C:\PROCESS\PROJECTS\60616465\INTERSECTION UPGRADES\019-SHT-1000-CI-0104.DWG

This drawing is confidential and shall only be used for the purpose of this project. The signing of this title block confirms the design and drafting of this project have been prepared and checked in accordance with the AECOM quality assurance system to ISO 9001-2000.

CONSULTANT
AECOM Australia Pty Ltd
A.B.N 20 093 846 925
www.aecom.com

PROJECT
Crown Street Improvements

CLIENT

SYDNEY CIVIL

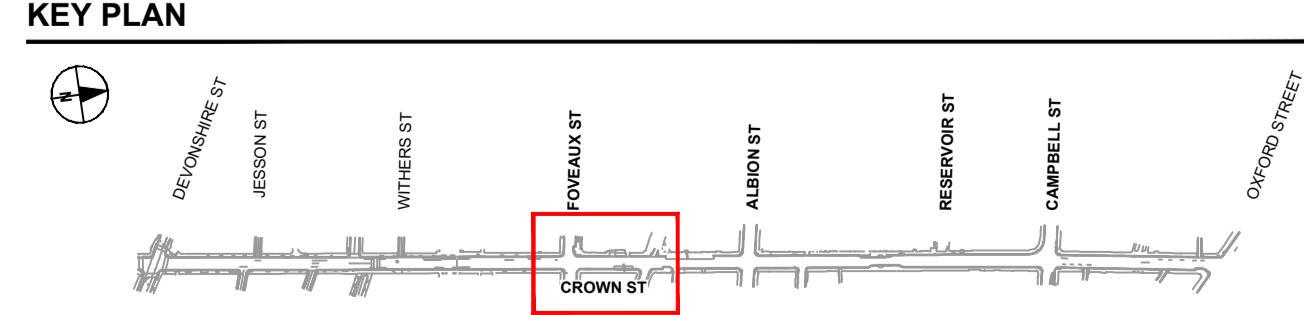
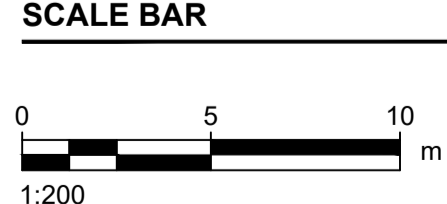

PROJECT MANAGEMENT INITIALS

ZJ	GS	RM
DESIGNER	CHECKED	APPROVED

PROJECT DATA

DATUM	MGA56	SURVEY	GDA 2020
-------	-------	--------	----------

ISSUE/REVISION

I/R	DATE	DESCRIPTION
05	29.06.2023	CONCEPT DESIGN
04	11.04.2023	CONCEPT DESIGN
03	24.03.2023	CONCEPT DESIGN
02	20.06.2022	CONCEPT DESIGN
01	15.02.2022	CONCEPT DESIGN

PROJECT NUMBER
60616465

SHEET TITLE
GENERAL ARRANGEMENT PLAN

SHEET NUMBER
SHEET 4

FOR INFORMATION ONLY

60616465-019-SHT-1000-CI-0104

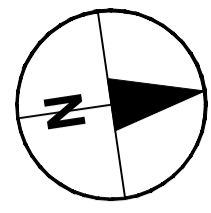

- ### NOTES
- FOR GENERAL NOTES REFER TO DRAWINGS 1000-CI-0005 AND 1000-CI-0006.
 - ALL LIGHT POTS SET BACK 1.0m TYPICAL FROM KERB FACE.
 - DRAINAGE AND STREET LIGHTING DESIGN SUBJECT TO FURTHER INVESTIGATION.
 - BUS PLINTH RELOCATION SUBJECT TO TFNSW APPROVAL.
 - INTERSECTION MODIFICATIONS SUBJECT TO TFNSW APPROVAL.
 - KERBS SHOWN AT 150mm WIDTH. AS PART OF DETAILED DESIGN, THIS WILL BE UPDATED TO 300mm TO SUIT A STONE KERB. THIS WILL IMPACT WIDTH OF LANDSCAPING ALONG CROWN STREET.

LEGEND

(1)	EXTENT OF WORKS	[Yellow grid pattern]	FOOTPATH WIDENING FOR STREET ACTIVATION
(2)	CONTINUOUS FOOTPATH TREATMENT AND BUILD OUT	[Grey grid pattern]	FOOTPATH UPGRADE WITH CONCRETE UNIT PAVERS
(3)	CONTINUOUS FOOTPATH TREATMENT ONLY	[Light grey grid pattern]	FOOTPATH REINSTATEMENT WITH GRANITE PAVERS
(3A)	IN-LANE BUS STOP	[Dark grey grid pattern]	FOOTPATH BUILD OUT
(4)	KERBSIDE BUS STOP	[Blue grid pattern]	CONTINUOUS FOOTPATH TREATMENT
(4)	RAISED PEDESTRIAN CROSSING	[Blue grid pattern]	ROAD PAVEMENT (MILL AND RE-SHEET)
(5)	SIGNALISED RAISED PEDESTRIAN CROSSING	[Blue grid pattern]	BUS STOP
(6)	EXISTING RAISED THRESHOLD TO BE RENEWED	[Blue grid pattern]	EXISTING BRICK PAVING TO BE RETAINED
(6)	PROPOSED BUS STOP FLAG	[Blue grid pattern]	EXISTING DINING ZONE TO BE RETAINED
(6)	EXISTING BUS STOP FLAG TO BE MAINTAINED	[Blue grid pattern]	EXISTING DINING ZONE TO BE RELOCATED
(6)	EXISTING BUS STOP FLAG TO BE REMOVED	[Blue grid pattern]	PROPOSED GARDEN BED WITH LOW GROWING SPECIES
(7)	PROPOSED TREE	[Green circle]	TREE PLANTING IN TREE PIT. TREE PLANTING DETAIL / TYPE TO BE COORDINATED WITH CoS
(8)	EXISTING TREES TO REMAIN	[White circle]	PROPOSED STREETLIGHT POLE
[TCS# 0000]	TCS PLAN REFERENCE	[Orange line]	EXISTING STREETLIGHT POLE

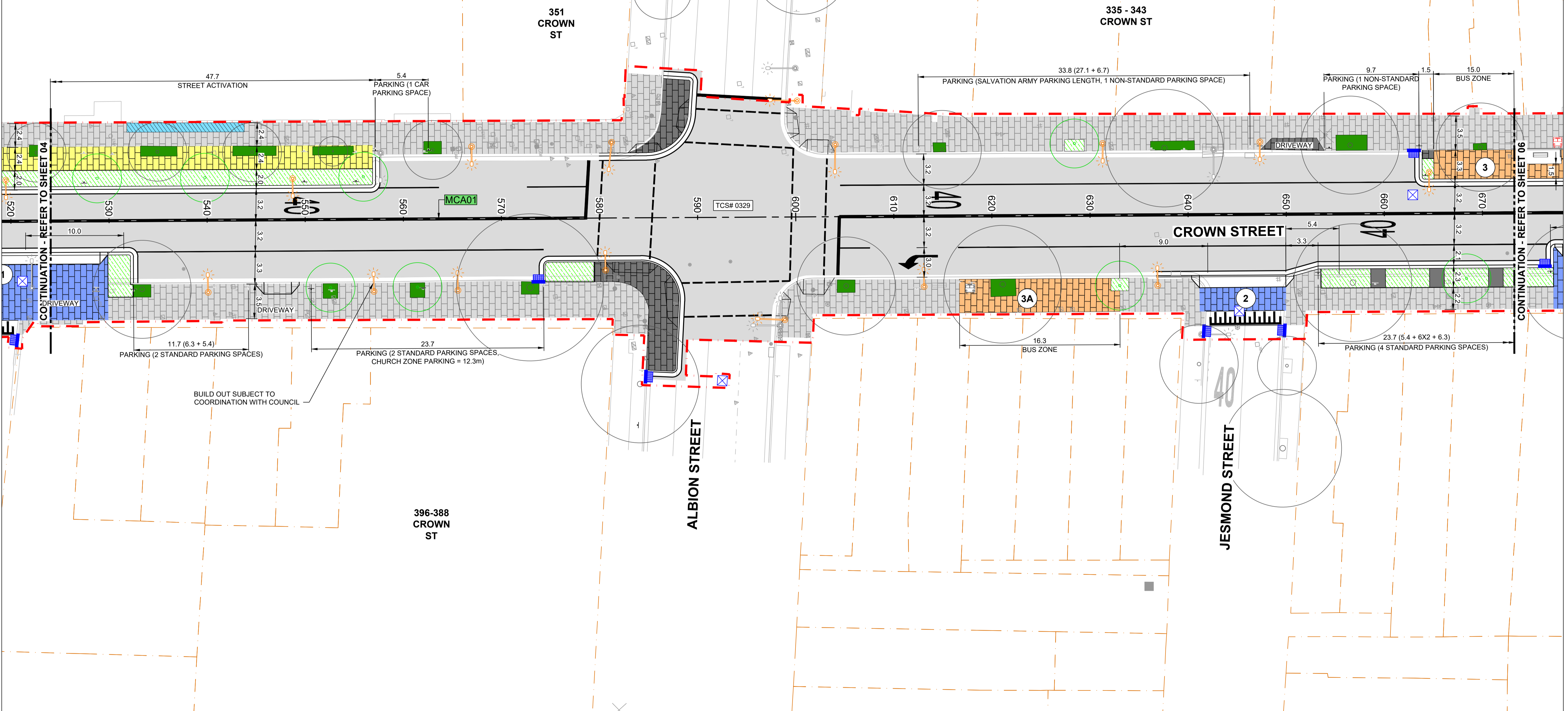

Last saved by: TOWNSEND/SW/2023.06.27, Last Plotted: 2023.06.29, Filename: C:\PROCESS\PROJECTS\60616465\INTERSECTION UPGRADES\019_CROWN_STREET\60616465-019-SHT-1000-CI-0105.DWG

This drawing is confidential and shall only be used for the purpose of this project. The signing of this title block confirms the design and drafting of this project have been prepared and checked in accordance with the AECOM quality assurance system to ISO 9001-2000.

CONSULTANT
AECOM Australia Pty Ltd
A.B.N 20 093 846 925
www.aecom.com

PROJECT
Crown Street Improvements

CLIENT
CITY OF SYDNEY
SYDNEY CIVIL

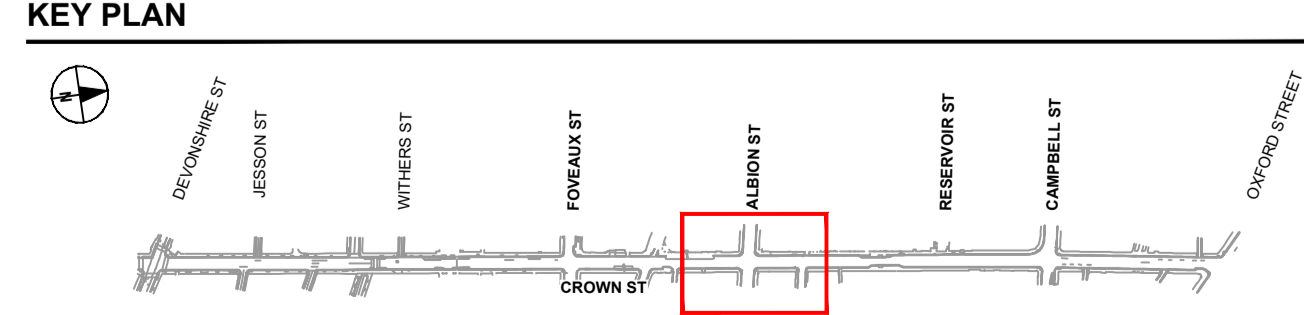
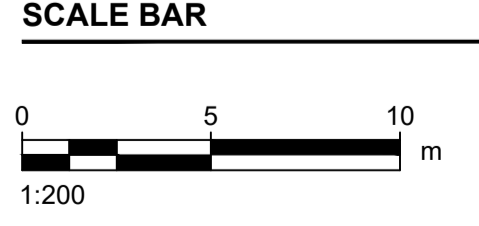

PROJECT MANAGEMENT INITIALS

ZJ	GS	RM
DESIGNER	CHECKED	APPROVED

PROJECT DATA

DATUM	MGA56	SURVEY	GDA 2020
-------	-------	--------	----------

ISSUE/REVISION

I/R	DATE	DESCRIPTION
04	29.06.2023	CONCEPT DESIGN
03	24.03.2023	CONCEPT DESIGN
02	20.06.2022	CONCEPT DESIGN
01	15.02.2022	CONCEPT DESIGN

PROJECT NUMBER
60616465

SHEET TITLE
GENERAL ARRANGEMENT PLAN

SHEET 5

SHEET NUMBER
60616465-019-SHT-1000-CI-0105

FOR INFORMATION ONLY

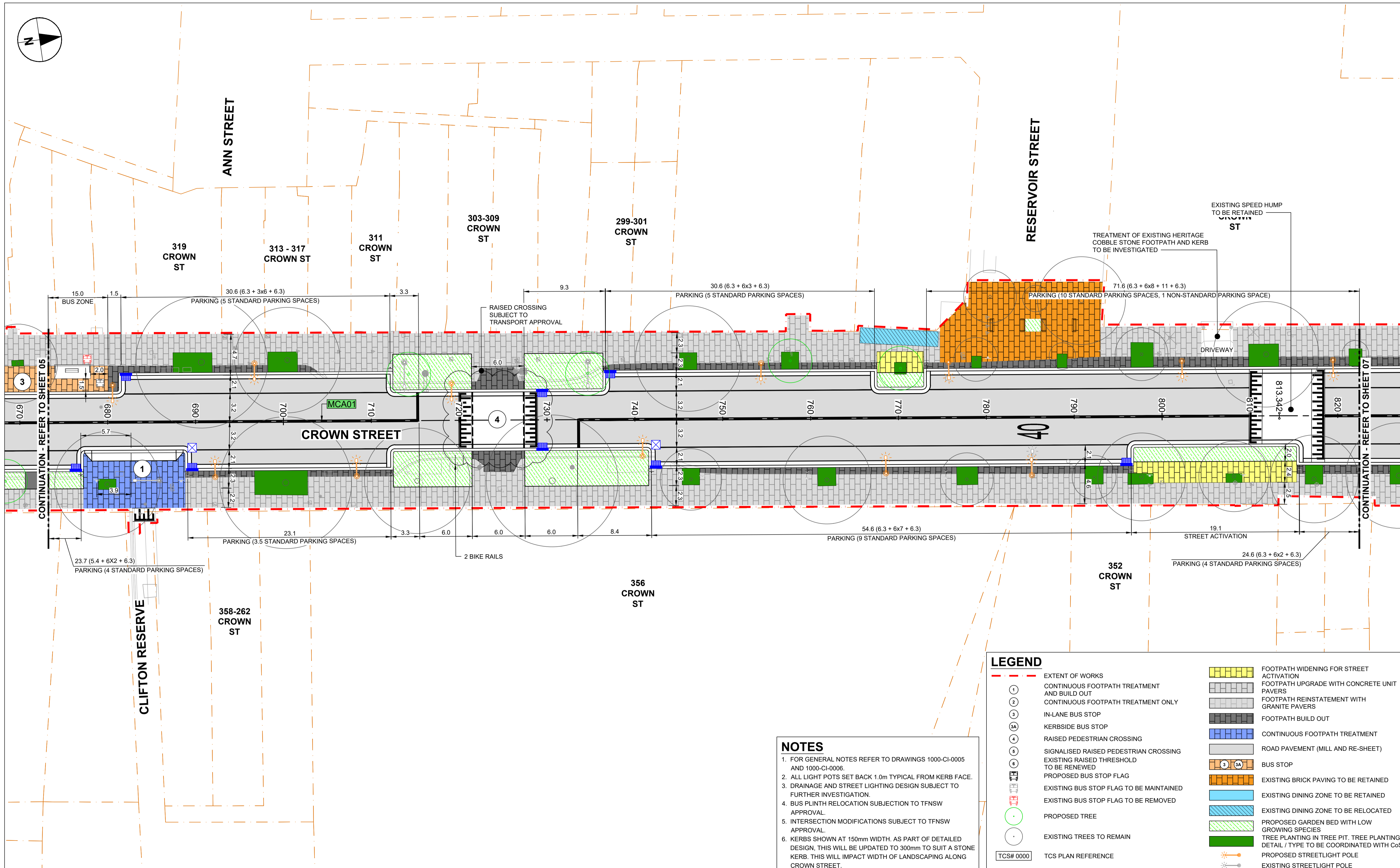
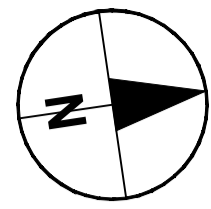

CONTINUATION - REFER TO SHEET 05

CONTINUATION - REFER TO SHEET 07

NOTES

- FOR GENERAL NOTES REFER TO DRAWINGS 1000-CI-0005 AND 1000-CI-0006.
- ALL LIGHT POTS SET BACK 1.0m TYPICAL FROM KERB FACE.
- DRAINAGE AND STREET LIGHTING DESIGN SUBJECT TO FURTHER INVESTIGATION.
- BUS PLINTH RELOCATION SUBJECT TO TFNSW APPROVAL.
- INTERSECTION MODIFICATIONS SUBJECT TO TFNSW APPROVAL.
- KERBS SHOWN AT 150mm WIDTH. AS PART OF DETAILED DESIGN, THIS WILL BE UPDATED TO 300mm TO SUIT A STONE KERB. THIS WILL IMPACT WIDTH OF LANDSCAPING ALONG CROWN STREET.

LEGEND

	EXTENT OF WORKS		FOOTPATH WIDENING FOR STREET ACTIVATION
	CONTINUOUS FOOTPATH TREATMENT AND BUILD OUT		FOOTPATH UPGRADE WITH CONCRETE UNIT PAVERS
	CONTINUOUS FOOTPATH TREATMENT ONLY		FOOTPATH REINSTATEMENT WITH GRANITE PAVERS
	IN-LANE BUS STOP		FOOTPATH BUILD OUT
	KERBSIDE BUS STOP		CONTINUOUS FOOTPATH TREATMENT
	RAISED PEDESTRIAN CROSSING		ROAD PAVEMENT (MILL AND RE-SHEET)
	SIGNALISED RAISED PEDESTRIAN CROSSING		BUS STOP
	EXISTING RAISED THRESHOLD TO BE RENEWED		EXISTING BRICK PAVING TO BE RETAINED
	PROPOSED BUS STOP FLAG		EXISTING DINING ZONE TO BE RETAINED
	EXISTING BUS STOP FLAG TO BE MAINTAINED		EXISTING DINING ZONE TO BE RELOCATED
	EXISTING BUS STOP FLAG TO BE REMOVED		PROPOSED GARDEN BED WITH LOW GROWING SPECIES
	PROPOSED TREE		TREE PLANTING IN TREE PIT. TREE PLANTING DETAIL / TYPE TO BE COORDINATED WITH CoS
	EXISTING TREES TO REMAIN		PROPOSED STREETLIGHT POLE
	TCS PLAN REFERENCE		EXISTING STREETLIGHT POLE

This drawing is confidential and shall only be used for the purpose of this project. The signing of this title block confirms the design and drafting of this project have been prepared and checked in accordance with the AECOM quality assurance system to ISO 9001-2000.

AECOM
CONSULTANT
AECOM Australia Pty Ltd
A.B.N 20 093 846 925
www.aecom.com

PROJECT
Crown Street Improvements

CLIENT
CITY OF SYDNEY
SYDNEY CIVIL

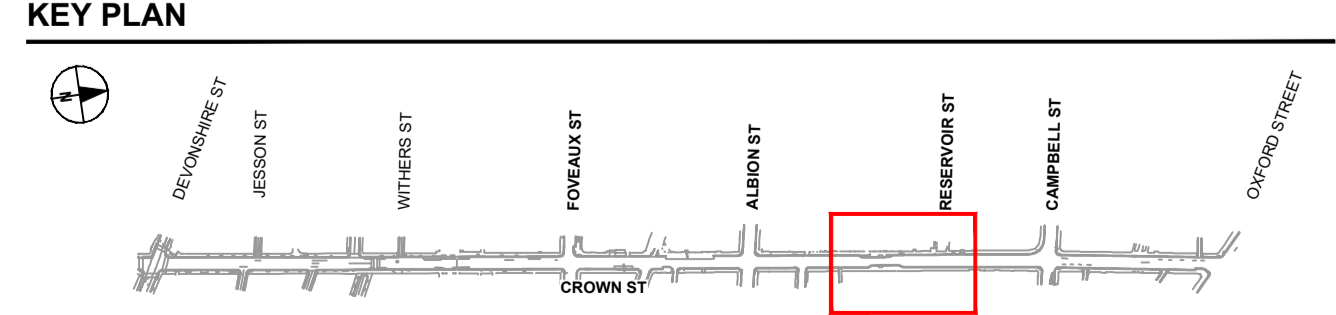
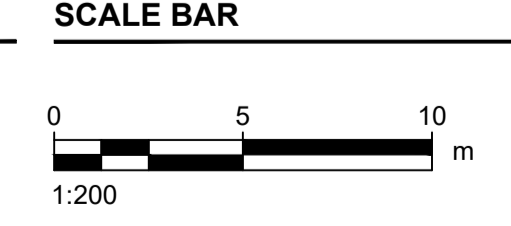

PROJECT MANAGEMENT INITIALS

ZJ	GS	RM
DESIGNER	CHECKED	APPROVED

PROJECT DATA

DATUM	MGA56	SURVEY	GDA 2020
-------	-------	--------	----------

ISSUE/REVISION

I/R	DATE	DESCRIPTION
04	29.06.2023	CONCEPT DESIGN
03	24.03.2023	CONCEPT DESIGN
02	20.06.2022	CONCEPT DESIGN
01	15.02.2022	CONCEPT DESIGN

PROJECT NUMBER
60616465
SHEET TITLE
GENERAL ARRANGEMENT PLAN
SHEET 6
SHEET NUMBER
60616465-019-SHT-1000-CI-0106

FOR INFORMATION ONLY

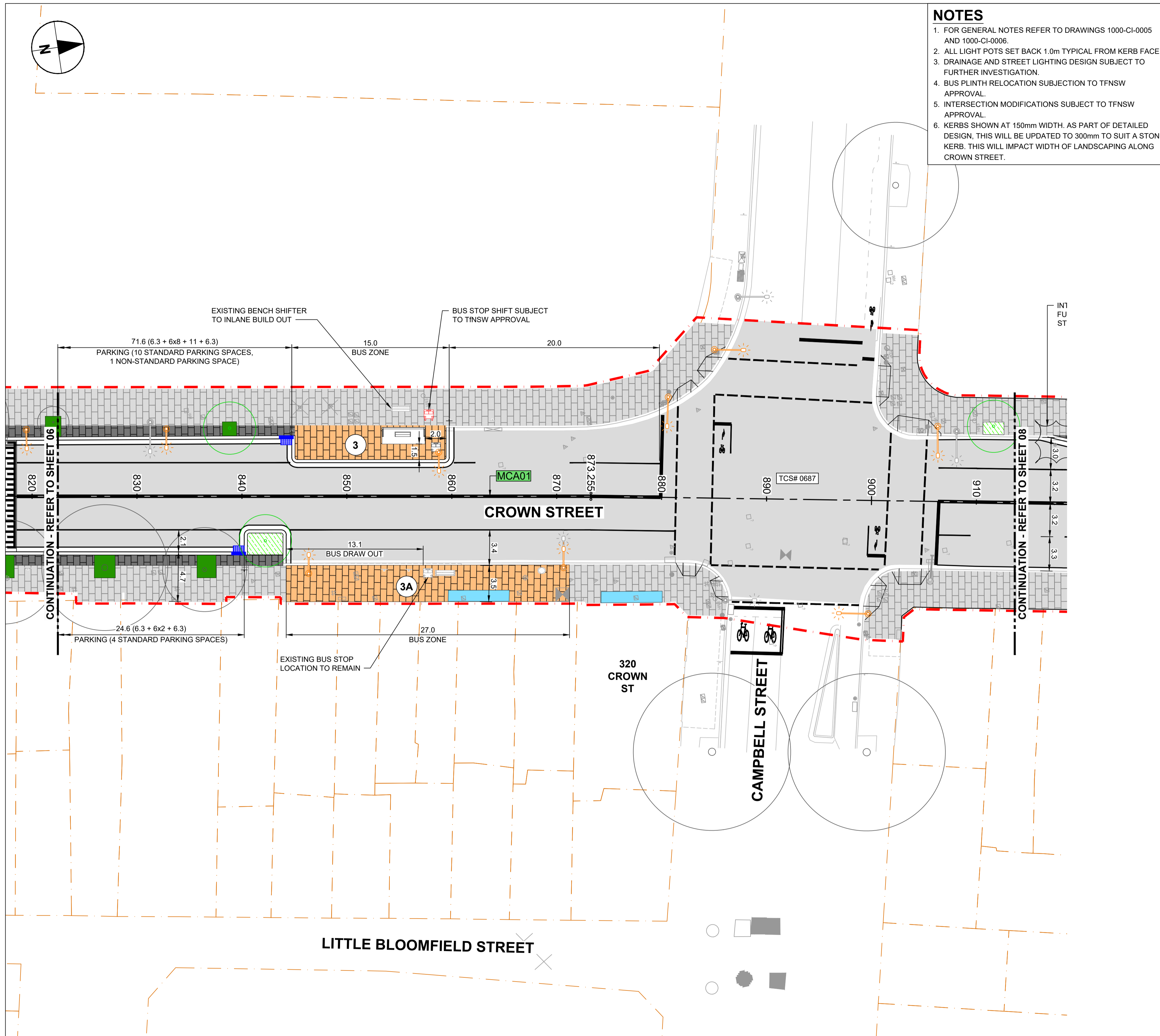

- ### NOTES
- FOR GENERAL NOTES REFER TO DRAWINGS 1000-CI-0005 AND 1000-CI-0006.
 - ALL LIGHT POTS SET BACK 1.0m TYPICAL FROM KERB FACE.
 - DRAINAGE AND STREET LIGHTING DESIGN SUBJECT TO FURTHER INVESTIGATION.
 - BUS PLINTH RELOCATION SUBJECT TO TFNSW APPROVAL.
 - INTERSECTION MODIFICATIONS SUBJECT TO TFNSW APPROVAL.
 - KERBS SHOWN AT 150mm WIDTH. AS PART OF DETAILED DESIGN, THIS WILL BE UPDATED TO 300mm TO SUIT A STONE KERB. THIS WILL IMPACT WIDTH OF LANDSCAPING ALONG CROWN STREET.

LEGEND

	EXTENT OF WORKS		FOOTPATH WIDENING FOR STREET ACTIVATION
	CONTINUOUS FOOTPATH TREATMENT AND BUILD OUT		FOOTPATH UPGRADE WITH CONCRETE UNIT PAVERS
	CONTINUOUS FOOTPATH TREATMENT ONLY		FOOTPATH REINSTATEMENT WITH GRANITE PAVERS
	IN-LANE BUS STOP		FOOTPATH BUILD OUT
	KERBSIDE BUS STOP		CONTINUOUS FOOTPATH TREATMENT
	RAISED PEDESTRIAN CROSSING		ROAD PAVEMENT (MILL AND RE-SHEET)
	SIGNALISED RAISED PEDESTRIAN CROSSING TO BE RENEWED		BUS STOP
	PROPOSED BUS STOP FLAG		EXISTING BRICK PAVING TO BE RETAINED
	EXISTING BUS STOP FLAG TO BE MAINTAINED		EXISTING DINING ZONE TO BE RETAINED
	EXISTING BUS STOP FLAG TO BE REMOVED		EXISTING DINING ZONE TO BE RELOCATED
	PROPOSED TREE		PROPOSED GARDEN BED WITH LOW GROWING SPECIES
	EXISTING TREES TO REMAIN		TREE PLANTING IN TREE PIT. TREE PLANTING DETAIL / TYPE TO BE COORDINATED WITH CoS
	TCS PLAN REFERENCE		PROPOSED STREETLIGHT POLE
			EXISTING STREETLIGHT POLE

This drawing is confidential and shall only be used for the purpose of this project. The signing of this title block confirms the design and drafting of this project have been prepared and checked in accordance with the AECOM quality assurance system to ISO 9001-2000.

AECOM Australia Pty Ltd
 A.B.N 20 093 846 925
 www.aecom.com

PROJECT
 Crown Street Improvements

CLIENT
 CITY OF SYDNEY

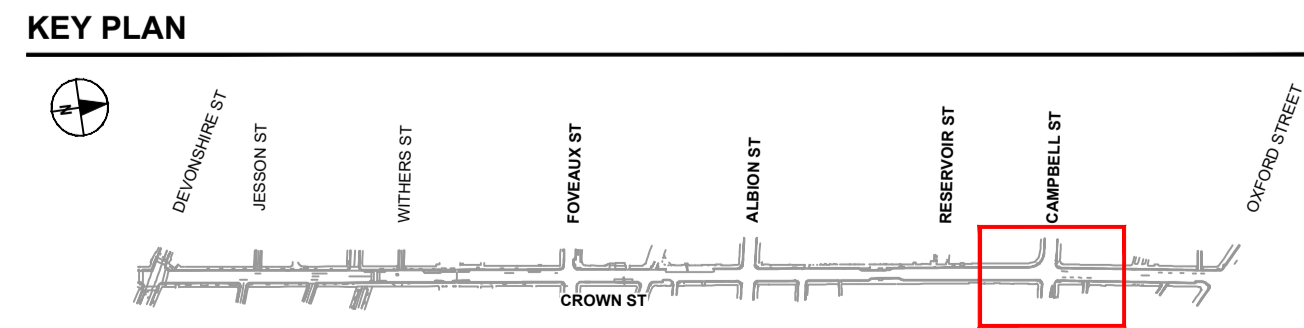
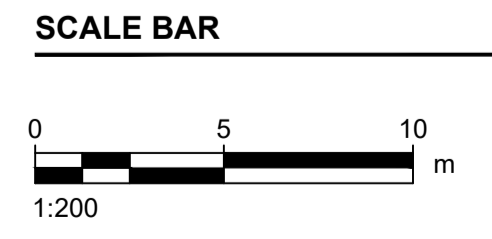

PROJECT MANAGEMENT INITIALS

ZJ	GS	RM
DESIGNER	CHECKED	APPROVED

PROJECT DATA

DATUM	MGA56	SURVEY	GDA 2020
-------	-------	--------	----------

ISSUE/REVISION

I/R	DATE	DESCRIPTION
05	29.06.2023	CONCEPT DESIGN
04	11.04.2023	CONCEPT DESIGN
03	24.03.2023	CONCEPT DESIGN
02	20.06.2022	CONCEPT DESIGN
01	15.02.2022	CONCEPT DESIGN

PROJECT NUMBER
 60616465

SHEET TITLE
 GENERAL ARRANGEMENT PLAN

SHEET 7

SHEET NUMBER
 60616465-019-SHT-1000-CI-0107

FOR INFORMATION ONLY

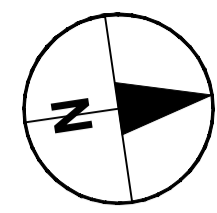

- NOTES**
- FOR GENERAL NOTES REFER TO DRAWINGS 1000-CI-0005 AND 1000-CI-0006.
 - ALL LIGHT POTS SET BACK 1.0m TYPICAL FROM KERB FACE.
 - DRAINAGE AND STREET LIGHTING DESIGN SUBJECT TO FURTHER INVESTIGATION.
 - BUS PLINTH RELOCATION SUBJECT TO TfNSW APPROVAL.
 - INTERSECTION MODIFICATIONS SUBJECT TO TfNSW APPROVAL.
 - KERBS SHOWN AT 150mm WIDTH. AS PART OF DETAILED DESIGN, THIS WILL BE UPDATED TO 300mm TO SUIT A STONE KERB. THIS WILL IMPACT WIDTH OF LANDSCAPING ALONG CROWN STREET.

- LEGEND**
- 1 EXTENT OF WORKS
 - 2 CONTINUOUS FOOTPATH TREATMENT AND BUILD OUT
 - 3 CONTINUOUS FOOTPATH TREATMENT ONLY
 - 4 IN-LANE BUS STOP
 - 5A KERBSIDE BUS STOP
 - 6 RAISED PEDESTRIAN CROSSING
 - 7 SIGNALISED RAISED PEDESTRIAN CROSSING
 - 8 EXISTING RAISED THRESHOLD TO BE RENEWED
 - 9 PROPOSED BUS STOP FLAG
 - 10 EXISTING BUS STOP FLAG TO BE MAINTAINED
 - 11 EXISTING BUS STOP FLAG TO BE REMOVED
 - 12 PROPOSED TREE
 - 13 EXISTING TREES TO REMAIN
 - TCS# 0000 TCS PLAN REFERENCE
 - FOOTPATH WIDENING FOR STREET ACTIVATION
 - FOOTPATH UPGRADE WITH CONCRETE UNIT PAVERS
 - FOOTPATH REINSTATEMENT WITH GRANITE PAVERS
 - FOOTPATH BUILD OUT
 - CONTINUOUS FOOTPATH TREATMENT
 - ROAD PAVEMENT (MILL AND RE-SHEET)
 - BUS STOP
 - EXISTING BRICK PAVING TO BE RETAINED
 - EXISTING DINING ZONE TO BE RETAINED
 - EXISTING DINING ZONE TO BE RELOCATED
 - PROPOSED GARDEN BED WITH LOW GROWING SPECIES
 - TREE PLANTING IN TREE PIT. TREE PLANTING DETAIL / TYPE TO BE COORDINATED WITH CoS
 - PROPOSED STREETLIGHT POLE
 - EXISTING STREETLIGHT POLE

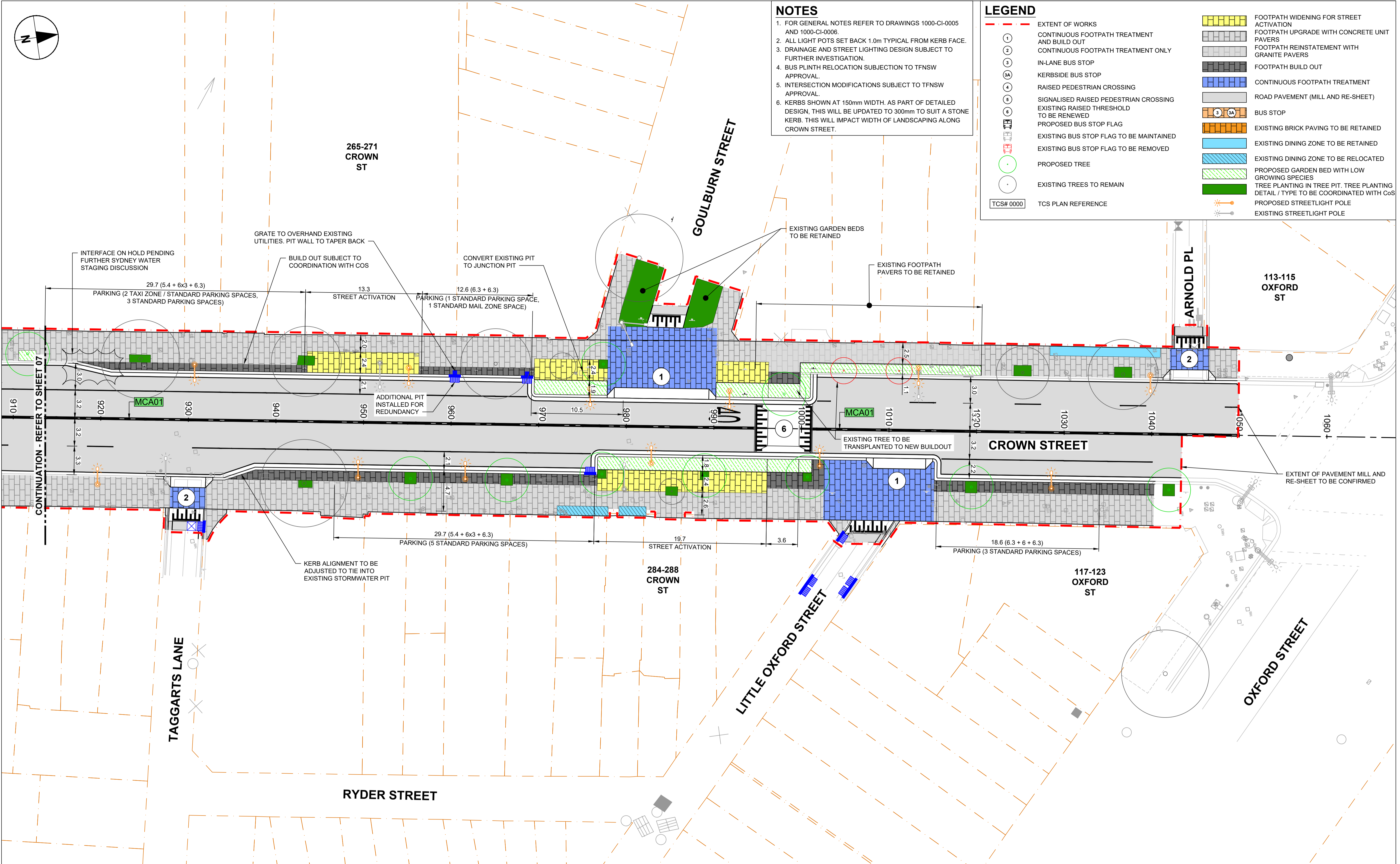

Last saved by: TOWNSEND/SW/2023_06-29, Last Plotted: 2023_06-29, Filename: C:\P\WORKING\AECOM_DS10_AUIS\AMUEL.TOWNSEND@AECOM.COM\1000-CI-0108.DWG

This drawing is confidential and shall only be used for the purpose of this project. The signing of this title block confirms the design and drafting of this project have been prepared and checked in accordance with the AECOM quality assurance system to ISO 9001-2000.

AECOM
CONSULTANT
AECOM Australia Pty Ltd
A.B.N 20 093 846 925
www.aecom.com

PROJECT
Crown Street Improvements

CLIENT
CITY OF SYDNEY
SYDNEY CIVIL

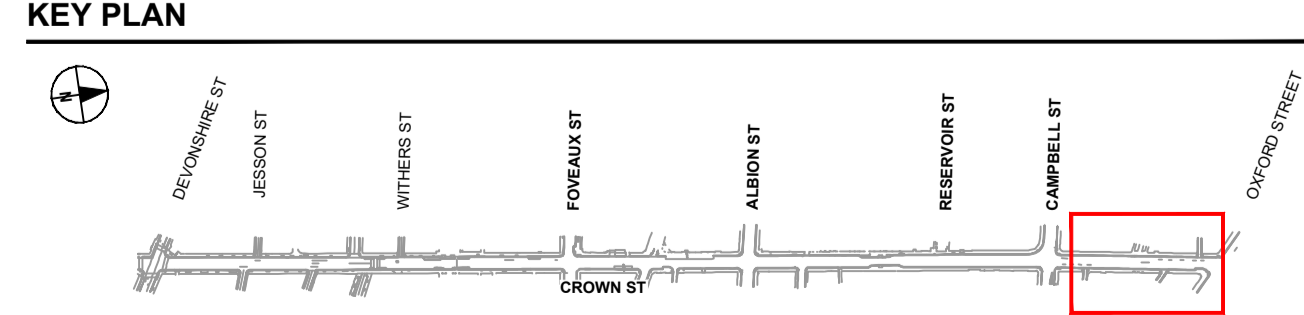
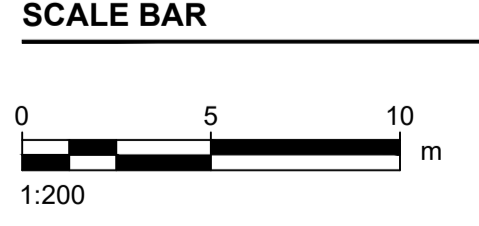

PROJECT MANAGEMENT INITIALS

ZJ	GS	RM
DESIGNER	CHECKED	APPROVED

PROJECT DATA

DATUM	MGA56	SURVEY	GDA 2020
-------	-------	--------	----------

ISSUE/REVISION

I/R	DATE	DESCRIPTION
04	29.06.2023	CONCEPT DESIGN
03	24.03.2023	CONCEPT DESIGN
02	20.06.2022	CONCEPT DESIGN
01	15.02.2022	CONCEPT DESIGN

PROJECT NUMBER
60616465

SHEET TITLE
GENERAL ARRANGEMENT PLAN
SHEET 8

SHEET NUMBER
60616465-019-SHT-1000-CI-0108

FOR INFORMATION ONLY